

# Kineticco International

## Product Catalogue





# Contents

---

<b>Kinetico World</b>	<b>06</b>
<b>Residential Water Softeners</b>	<b>14</b>
<b>Commercial Water Softeners</b>	<b>24</b>
<b>Water Filtration Systems</b>	<b>34</b>
<b>Combination Systems</b>	<b>40</b>
<b>Drinking Water Systems</b>	<b>46</b>
<b>Commercial Reverse Osmosis</b>	<b>54</b>
<b>Hydrus</b>	<b>62</b>
<b>FAQs</b>	<b>68</b>

---

# Key



## Block Salt

The softener can be loaded with block salt for the end user's convenience.



## Tablet Salt

The system accepts tablet salt.

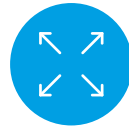

## Large Salt Capacity

The system comes with a large brine drum that can be loaded with a larger quantity of salt, thus lasting longer between refills.



## Easy Maintenance

The system is easy to maintain and does not require excessive maintenance after installation.

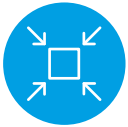

## Compact Design

Small and compact, the system is designed to take up as little space as possible.



## Fits Under Kitchen Cabinet

Designed to fit under most kitchen cabinets, the compact system can easily integrate into any kitchen layout.



## On Casters/ Movable

The system can be mounted on casters for ease of movement. Particularly useful if the location is ever changing.



## Non-electric

By using the kinetic energy of moving water to power our systems, we eliminate the need for electricity anywhere near the unit!



## Single Tank

The single tank design ensures great performance with minimal regeneration time.



## Twin-tank

Guaranteed to provide an uninterrupted supply of soft water 24 hours a day, 7 days a week.



## Dual

Two systems in one! A softener plus a filter in one unit, perfect when space is at a premium.



## Variable Media Options

The unit can be customised to your exact needs, simply by choosing the media that will best solve your problems.



### Carbon Filtration

Highly absorbent carbon filters absorb impurities in the water.



### Reverse Osmosis

Uses a semi-permeable membrane that only water can pass through.



### MACguard®

Shuts off the supply to the tap automatically when the cartridge has expired, ensuring only filtered water is available.



### PureMometer®

The PureMometer® will indicate when the filter cartridge needs to be changed.



### High Hardness Capacity

Designed to soften water with a very high hardness content.



### High Temperature

The unit is suitable for applications where there is a need for treatment of hot water.



### High Flow Rate

A guaranteed, continuous high flow of water.



### Bio-pure

Medical grade filter removes 99.99% of viruses and bacteria.



### Soft Water Rinse

Prolongs the life of the system by cleaning itself with the very same high-quality water it produces.

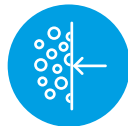

### EverClean Rinse®

Prolongs the life of the RO membrane by self-cleaning with the high-quality water produced by the system.



### Clean Water Rinse

Prolongs the lifetime of the filter by cleaning itself with the same high quality filtered water it produces.



### High Efficiency

Very efficient unit with accurate regeneration to guarantee the best performance.



### Durable Design

Designed and built to withstand moist, dusty and dirty conditions.



### Quick Connect / Easy Install

Easy to connect and install with no timers or complicated mechanisms to set.



### Extra Precision Hardness Setting

System can be configured to individual households, improving performance and reducing salt consumption.



### Euro Pallet

Units per EU pallet.



### Industrial Pallet

Units per industrial pallet.



# Kinetico World

---

At Kinetico, we believe life is better with better water, and making things better is the philosophy behind everything we do. From the extra care and thinking that goes into engineering and manufacturing our water treatment products, to the way we engage with and recognise our employees, we are always looking for a better way of doing things. In fact, that's how Kinetico began.

In 1970, Kinetico was founded by two engineers who were looking to design a better water softener. After years of trials and testing, they built the world's first twin-tank, demand operated, non-electric water softener which revolutionised the water treatment industry.

Kinetico is now an Axel Johnson Inc. company, but the same principles of innovation, creativity and forward-thinking are still behind everything we do. Millions of people around the world have chosen Kinetico to solve their water problems, and we are sure millions more will trust us to do the same in the future.

We never stop innovating and are always working to improve our products and the way we bring better water to your home, your business and your life.

We know you have many choices when it comes to selecting a water treatment product. But rest assured, with Kinetico, you have a world-wide team of intelligent, caring, thoughtful and dedicated people working to make your life better.

We are thankful for our great network of dealers around the world who support the growth and development of Kinetico, along with their own businesses. **We invite you to come and join our community of highly skilled dealers across the globe and begin a mutually fruitful cooperation today!**

# Our Mission

---

Worldwide and irrespective of our location, we work together with a common mission.

- A commitment to be an innovative, customer-oriented, global supplier of water conditioning products and systems, offering the highest quality solutions and excellent service to customers.
- A determination to monitor water use and preservation to meet today's global economic and environmental needs, without compromising the opportunity for future generations to meet theirs.
- A focus on business areas with a significant opportunity to deliver the best performance on the water treatment market.

We aim to deliver superior service to our customers. Not only are we producers of state-of-the-art technology that challenge industry standards, but we are pioneers constantly innovating and striving to be better. We concentrate on building strong relationships with our customers and we understand how important our support is to the success of a Kinetico Dealer, this is

why we put extra effort into making sure our dealers are happy working with us.

By sharing the same belief that an excellent product and great service make for a happy customer, Kinetico chooses its dealers carefully. Our proof, hundreds of thousands of satisfied households, worldwide, enjoying pure water by Kinetico. Furthermore, vast numbers of businesses and various commercial applications enjoying spectacular results from their investments in Kinetico water treatment systems.



# Our Product Range

Innovation and reliability run throughout our range of products, spanning from neat, compact residential systems, to large scale industrial units.



## Compact systems:

Kinetico offer a complete range of products for residential applications and locations with limited space.

Though they are small, compact systems are suitable for the most demanding needs, and sophisticated specifications.

### Suitable for...

Residential/Household  
Hotels  
Kitchens  
Restaurants



## Medium systems:

Our hydro powered systems are perfect for medium sized service industries and commercial premises. The non-electric units, without the requirement of electrical control switches, have a great flexibility when determining a suitable location. The simple modular design allows for the systems to grow when your needs begin to grow.

### Suitable for...

Building complexes  
Healthcare  
Schools and institutions  
Cleaning  
Food and beverage



## Large systems:

Kinetico has years of experience in providing custom engineered water treatment solutions for large industrial applications.

The modular design allows for any size of project to be fulfilled by Kinetico systems.

### Suitable for...

Industrial processing  
Energy  
Other

# The Kinetico Difference



## Powered by better thinking:

Founded in 1970, Kinetico invented the non-electric, fully automatic water softener. Today, Kinetico continues to produce brilliantly engineered water treatment systems, recognised as being the most efficient and effective in the world.

### This means...

You get a tried and tested system of superior quality, based on many years of experience and innovation.



## Non-electric:

Kinetico uses the kinetic energy of moving water to power its systems instead of electricity - after all water and electricity don't mix!

### This means...

You never have to worry about costly repairs of fragile electric components or power. With Kinetico you get reliability!



## Twin-tank design:

The twin-tank design is the only system to backwash without ever going offline (i.e. cannot supply soft water) while regenerating.

### This means...

You are guaranteed a 24/7, continuous and un-interrupted supply of soft water. The purpose of a water softener is to produce soft water and with a Kinetico system there are no exceptions.



## Demand driven regeneration:

Meters water use to accurately determine when it's time to regenerate, with watch-like precision. This results in less waste and greater savings.

### This means...

A Kinetico system will regenerate only when necessary, providing optimal efficiency.

All the features listed above apply to the twin-tank water softeners and filters listed in this catalogue.



### **Soft/clean water rinse:**

A Kinetico softener uses only soft water to clean itself, and a Kinetico filter uses only filtered water to clean itself, this prolongs the life of the systems. In fact, the longest serving Kinetico Water Softener is currently 42 years old!

#### **This means...**

Kinetico systems are built to last!

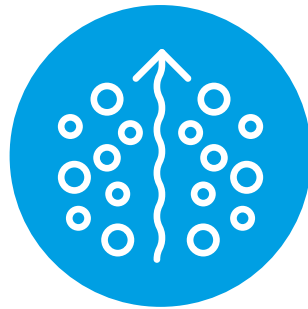

### **Countercurrent regeneration:**

Kinetico systems regenerate in the smartest way possible. Unlike other softeners, they regenerate from the bottom up. The result is less waste and lower salt usage.

#### **This means...**

The system is cleaned better, ensuring it lasts longer and its users are more satisfied with lower operational costs.



### **Unmatched performance:**

Our systems treat water efficiently, effectively and economically. There will be no interruptions in performance and you can be confident they will outperform other options available.

#### **This means...**

With Kinetico, you get the best performing machines from the pioneers of non-electric water treatment. Don't settle for a copy.

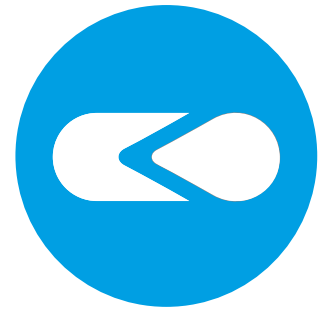

### **Tailored solutions:**

Kinetico systems take the guesswork out of water treatment. They perfectly understand water and its many differences in various locations around the world.

#### **This means...**

You will be provided with water treatment options tailored to your water needs and business requirements.

# Our Awards, Certifications & Memberships



## Water Quality Association:

The Water Quality Association (WQA) is a not-for-profit international trade association representing the residential, commercial and industrial water treatment industry. WQA maintains a close dialogue with other organizations representing different aspects of the water industry in order to best serve consumers, government officials, and industry members.



## NSF certified:

The mission of the NSF is to protect and improve global human health. As an independent, accredited organization, they develop standards, and test and certify products and systems.

The NSF mark assures consumers, retailers and regulators that products have been rigorously tested to comply with all standard requirements.



## CE Mark:

CE marking is a mandatory conformity marking for certain products sold within the European Economic Area (EEA) since 1985.

The CE marking is the manufacturer's declaration that the product meets the requirements of the applicable EC directives.



## WRAS approved product:

The Water Regulations Advisory Scheme (WRAS) is the UK Water Industry's approval scheme. Products approved by the scheme have been shown to comply with the requirements of the Water Supply (Water Fittings) Regulations 1999 and amendments.

The above accreditations only apply to certain products, please ask for details.



## ACS certified:

The ACS (Attestation de conformité sanitaire) is the French health authorities certification to sanitary conformity.

It evaluates the suitability of a product to come into contact with water destined for human consumption. The decree is applicable to plastic material objects as well as accessories containing at least one plastic component in contact with drinking water.



## EWTA member:

The European Water Treatment Association (EWTA) is a trade association representing European manufacturers, suppliers and other relevant organisations involved with treatment of public or private water supplies in the home or in commercial establishments, at point of entry (POE) to the premises and point of use (POU).

GOLD AWARD WINNER



Best Kitchen & Household Product

## House Beautiful Awards Winner:

The House Beautiful Awards are judged by an expert panel. They are obsessed with finding the best items for the home - items that not only look good but also make life better.

‘Customers can really trust that they’re getting great value and the most exacting standards from every company that has won.’

Julia Goodwin, Editor.



## Build It Awards Winner:

The Build It awards celebrate all aspects of self-build and renovation. They bring together architects, manufacturers and key industry figures in recognition of innovation and excellence in the custom and self build home sector.

The Premier Compact won the award for best plumbing and drainage product. “A clever solution to a long-term maintenance issue that affects many self builders and renovators.”



# Residential Water Softeners

---

Kinetico Water Softeners are designed to get to the source of the problem and make your water soft, while using very little of the space in your home. Our systems are brilliantly designed to eliminate limescale problems.

Kinetico softeners are designed to fulfil all of your water demands. Stylish cabinets that are built to last, twin or single tank systems to meet your needs and very small to larger systems guaranteed to fit the space available.

They also use as little salt and water as possible to remove limescale from your home and help you save money. This is achieved through demand operated regeneration, which forces the unit to regenerate only when it is needed and not when indicated by a timer. The non-electric design

allows for installation at the most appropriate place in the home, rather than being dictated by a location with an electrical connection.

Kinetico systems minimize waste, energy usage and the impact on our environment. Our softeners are made to remove more impurities and perform more efficiently with lower lifetime costs.

# Residential Water Softening made easy with Kinetico



## Say goodbye to...

Costly limescale removers and harsh chemical cleaners.

## Say goodbye to...

Crusty taps, watermarked shower screens and clogged showerheads.





# The Range

## Duplex Water Softener Range



**Premier Plus XP**



**Premier Compact XP**



**Premier 2050s**



**Premier 2040s OD**



**AquaKinetic**

## Simplex Water Softener Range



**Essential 17**



**Essential 11**



**Essential 8**



**Sumo II and I**

# Premier Plus XP

**Our superior non-electric, twin-tank water softener ideal for larger homes.**

The Premier Plus is a high performance, semi-commercial water softener. This system has all the same benefits as the award-winning Premier Compact, but with a faster flow rate to cope with larger demand.

- For larger family households.
- Regenerates based on demand.
- Uses block or tablet salt, which are easily loaded into the front of the unit.
- Uses a process of “ion-exchange” to soften the water.



**Specifications:**

<b>Dimensions</b>	
<b>System (w x d x h)</b>	480 x 400 x 655 mm
<b>Weight</b>	49 kg
<b>Performance</b>	
<b>Minimum Flow</b>	1,1 l/min
<b>Maximum Flow @ 1 Δ bar</b>	22,7 l/min
<b>Hardness as CaCO3 (max)</b>	885 mg/l
<b>Regeneration</b>	
<b>Salt Used / Capacity</b>	0,45 / 2 x 11 kg
<b>Time</b>	12 minutes
<b>Volume</b>	28 litres
<b>System</b>	
<b>Media Volume</b>	2 x 11 litres
<b>Inlet/Outlet Connections</b>	Custom
<b>Temperature Range</b>	2 - 49°C
<b>Inlet Pressure (Min/Max)</b>	2 / 8 bar



# Premier Compact XP

The Kinetico Premier Compact with e-max technology combines maximum performance and efficiency in a compact design - the ultimate in soft water convenience.

With e-max technology, Premier Compact balances optimum efficiency and maximum performance to give an unparalleled level of limescale prevention.

- For smaller households.
- Regenerates based on demand.
- Uses block or tablet salt, which are easily loaded into the front of the unit.
- Uses a process of "ion-exchange" to soften the water.



## Specifications:

<b>Dimensions</b>	
<b>System (w x d x h)</b>	219 x 468 x 498 mm
<b>Weight</b>	17 kg
<b>Performance</b>	
<b>Minimum Flow</b>	1,1 l/min
<b>Maximum Flow @ 1 Δ bar</b>	22,7 l/min
<b>Hardness as CaCO<sub>3</sub> (max)</b>	528 mg/l
<b>Regeneration</b>	
<b>Salt Used / Capacity</b>	0,34 / 2 x 4 kg
<b>Time</b>	11 minutes
<b>Volume</b>	20,5 litres
<b>System</b>	
<b>Media Volume</b>	2 x 4,5 litres
<b>Inlet/Outlet Connections</b>	Custom
<b>Temperature Range</b>	2 - 49°C
<b>Operating Pressure</b>	2 / 8 bar



18

17599B

## Premier 2050s

The Premier 2050s has been designed with a separate brine tank, this enables the use of multiple salt options.

- Twin-tank, non-electric water softener.
- Economical to use.



### Specifications:

<b>Dimensions</b>	
<b>System (w x d x h)</b>	432 x 203 x 584 mm
<b>Weight</b>	41 - 54 kg
<b>Performance</b>	
<b>Minimum Flow</b>	1,1 l/min
<b>Maximum Flow @ 1 Δ bar</b>	22,7 l/min
<b>Hardness as CaCO<sub>3</sub> (max)</b>	804 mg/l
<b>Regeneration</b>	
<b>Salt Used / Capacity</b>	0,45 / 25 kg
<b>Time</b>	11 minutes
<b>Volume</b>	26,5 litres
<b>System</b>	
<b>Media Volume</b>	2 x 11 litres
<b>Inlet/Outlet Connections</b>	Custom
<b>Temperature Range</b>	2 - 49°C
<b>Inlet Pressure (Min/Max)</b>	2,0 / 8,6 bar



8

11112

## Premier 2040s OD

The Kinetico Premier 2040s OD is an independently certified, high performing, non-electric water softener.

- Simple, reliable and economical operation.
- Twin-tank design.



### Specifications:

<b>Dimensions</b>	
<b>System (w x d x h)</b>	432 x 203 x 584 mm
<b>Weight</b>	41 - 54 kg
<b>Performance</b>	
<b>Minimum Flow</b>	1,1 l/min
<b>Maximum Flow @ 1 Δ bar</b>	41,6 l/min
<b>Hardness as CaCO<sub>3</sub> (max)</b>	752 mg/l
<b>Regeneration</b>	
<b>Salt Used / Capacity</b>	0,45 / 23 kg
<b>Time</b>	11 minutes
<b>Volume</b>	26,5 litres
<b>System</b>	
<b>Media Volume</b>	2 x 11 litres
<b>Inlet/Outlet Connections</b>	Custom
<b>Temperature Range</b>	2 - 49°C
<b>Inlet Pressure (Min/Max)</b>	2,0 / 8,6 bar



8

11120

## AquaKinetic

A high performance, ultra-compact water softener, the AquaKinetic can fit into the smallest of spaces.

- Twin-tank, non-electric water softener.
- Economical to use, also available with casters.



### Specifications:

Dimensions		
<b>System (w x d x h)</b>	178 x 457 x 508 mm	
<b>Weight</b>	21 kg	
Type	HT	HF
Performance		
<b>Minimum Flow</b>	2 l/min	2 l/min
<b>Maximum Flow @ 1 Δ bar</b>	19,3 l/min	19,3 l/min
<b>Hardness as CaCO<sub>3</sub> (max)</b>	513 mg/l	513 mg/l
Regeneration		
<b>Salt Used / Capacity</b>	0,45 / 9 kg	0,23/ 9 kg
<b>Time</b>	11 minutes	11 minutes
<b>Volume</b>	34 litres	24 litres
System		
<b>Media Volume</b>	2 x 4,5 litres	2 x 4,5 litres
<b>Inlet/Outlet Connections</b>	Custom	Custom
<b>Temperature Range</b>	2 - 65°C	2 - 49°C
<b>Inlet Pressure (Min/Max)</b>	2,0 / 8,6 bar	2,0 / 8,6 bar



18

HT: 110064

HF: 110063

## Essential 17

The biggest single-tank softener from the Essential series, yet still with a stylish cabinet design.

- Non-electric, single tank softener.
- Quick, easy installation and worry-free maintenance.



### Specifications:

Dimensions		
<b>System (w x d x h)</b>	303 x 503 x 785 mm	
<b>Weight</b>	26,8 - 86,2 kg	
Performance		
<b>Minimum Flow</b>	2,8 l/min	
<b>Maximum Flow @ 1 Δ bar</b>	34 l/min	
<b>Hardness as CaCO<sub>3</sub> (max)</b>	967 mg/l	
Regeneration		
<b>Salt Used / Capacity</b>	0,73 / 49,9 kg	
<b>Time</b>	15 minutes	
<b>Volume</b>	32 litres	
System		
<b>Media Volume</b>	16,7 litres	
<b>Inlet/Outlet Connections</b>	Custom	
<b>Temperature Range</b>	2 - 49°C	
<b>Inlet Pressure (Min/Max)</b>	2 / 8,6 bar	



8

15852-INT

## Essential 11

Essential 11 is a very compact, yet powerful softening unit with a great performance.

- Single tank, non-electric water softening unit.
- See-through lid indicates accurate salt replacement.



### Specifications:

<b>Dimensions</b>	
<b>System (w x d x h)</b>	298 x 501 x 608 mm
<b>Weight</b>	22,7 - 59 kg
<b>Performance</b>	
<b>Minimum Flow</b>	2,8 l/min
<b>Maximum Flow @ 1 Δ bar</b>	36 l/min
<b>Hardness as CaCO<sub>3</sub> (max)</b>	730 mg/l
<b>Regeneration</b>	
<b>Salt Used / Capacity</b>	0,36 / 27 kg
<b>Time</b>	15 minutes
<b>Volume</b>	25 litres
<b>System</b>	
<b>Media Volume</b>	10,5 litres
<b>Inlet/Outlet Connections</b>	Custom
<b>Temperature Range</b>	2 - 49°C
<b>Inlet Pressure (Min/Max)</b>	2 / 8,6 bar



12

15988-INT

## Essential 8

A very compact, sophisticated water softener suitable for various applications.

- Single tank, non-electric water softener.
- Easy maintenance and efficient salt usage.



### Specifications:

<b>Dimensions</b>	
<b>System (w x d x h)</b>	293 x 498 x 506 mm
<b>Weight</b>	14,5 - 45,4 kg
<b>Performance</b>	
<b>Minimum Flow</b>	2,8 l/min
<b>Maximum Flow @ 1 Δ bar</b>	36 l/min
<b>Hardness as CaCO<sub>3</sub> (max)</b>	600 mg/l
<b>Regeneration</b>	
<b>Salt Used / Capacity</b>	0,36 / 23,6 kg
<b>Time</b>	15 minutes
<b>Volume</b>	25 litres
<b>System</b>	
<b>Media Volume</b>	7,4 litres
<b>Inlet/Outlet Connections</b>	Custom
<b>Temperature Range</b>	2-49°C
<b>Inlet Pressure (Min/Max)</b>	2 / 8,6 bar



12

15937-INT

## Sumo II

The Sumo II is a highly efficient water softener. It measures water use to regenerate only when necessary.

- Non-electric and economical to use.
- Easy to maintain, single-tank system.



### Specifications:

<b>Dimensions</b>	
<b>System (w x d x h)</b>	345 x 555 x 601 mm
<b>Weight</b>	30 - 60 kg
<b>Performance</b>	
<b>Minimum Flow</b>	2,8 l/min
<b>Maximum Flow @ 1 Δ bar</b>	35 l/min
<b>Hardness as CaCO<sub>3</sub> (max)</b>	850 mg/L
<b>Regeneration</b>	
<b>Salt Used / Capacity</b>	0,59 / 40 kg
<b>Time</b>	18 minutes
<b>Volume</b>	38 litres
<b>System</b>	
<b>Media Volume</b>	15,6 litres
<b>Inlet/Outlet Connections</b>	3/4"
<b>Temperature Range</b>	2 - 49°C
<b>Inlet Pressure (Min/Max)</b>	2 / 8,0 bar



8

14778

## Sumo I

An advanced, non-electric water softener, the Sumo I is a compact system with a smart valve softening engine.

- Compact and efficient single-tank softener.
- Easy to install.



### Specifications:

<b>Dimensions</b>	
<b>System (w x d x h)</b>	235 x 420 x 492 mm
<b>Weight</b>	15 - 30 kg
<b>Performance</b>	
<b>Minimum Flow</b>	2,8 l/min
<b>Maximum Flow @ 1 Δ bar</b>	30 l/min
<b>Hardness as CaCO<sub>3</sub> (max)</b>	525 mg/L
<b>Regeneration</b>	
<b>Salt Used / Capacity</b>	0,27 / 22 kg
<b>Time</b>	12 minutes
<b>Volume</b>	25 litres
<b>System</b>	
<b>Media Volume</b>	5,7 litres
<b>Inlet/Outlet Connections</b>	3/4"
<b>Temperature Range</b>	2 - 49°C
<b>Inlet Pressure (Min/Max)</b>	2 / 8,0 bar



18

14776





# Commercial Water Softeners

---

Kinetico has a variety of commercial softeners that span every need, from the smallest intermittent process requirement to the largest continuous flow application. The advanced design of a Kinetico commercial solution allows flexibility in set-up and operation. Our softeners are fitted with a non-electric control valve to provide a continuous flow of treated water.

The twin-tank design ensures uninterrupted water treatment, and the multiple sizes, ranging from small to large industrial systems, ensure there is a Kinetico solution for every commercial application with a need for treated water. Kinetico has implemented the experience and skills gained working in water treatment for nearly half a century, to put the best into each and every unit. Kinetico

will support the needs of your business from start to finish.

And, we know that needs can vary. This is why we invented and patented the technology that can handle high flow rates, very high hardness levels, high temperatures and demanding space requirements.

# Commercial Water Softening made easy with Kinetico



## Say goodbye to...

Rough, faded towels and the need for frequent linen replacement.

## Say goodbye to...

Limescale and watermarks on fixtures, ruining your stylish interiors, costly outlays on detergents plus expensive repairs and maintenance.



# The Range

## Commercial Water Softener Range



**Premier 2030s**



**Premier 2060s**  
Standard and OD



**Premier 2100s**  
Standard and OD



**Premier 2175s**



**CP 213s**  
Standard and OD



**CP 216s**  
Standard and OD

## Compact Commercial Water Softener Range



**CC 206c**



**CC 208c**



**AquaKinetic HT**



**Kinetic Simplex H**

## Premier 2030s

An advanced commercial water softener, the Premier 2030s is flexible in both set up and operation.

- Small but powerful water treatment unit.
- Twin-tank, non-electric water softener.



### Specifications:

<b>Dimensions</b>	
<b>System</b>	381 x 178 x 1041 mm
<b>Weight</b>	47,6 - 64 kg
<b>Performance</b>	
<b>Minimum Flow</b>	1,1 l/min
<b>Maximum Flow @ 1 Δ bar</b>	34 l/min
<b>Hardness as CaCO<sub>3</sub> (max)</b>	770 mg/l
<b>Regeneration</b>	
<b>Salt Used / Capacity</b>	0,82 - 1,4 / 114 kg
<b>Time</b>	40 minutes
<b>Volume</b>	110 litres
<b>System</b>	
<b>Media Volume</b>	2 x 13,3 litres
<b>Inlet/Outlet Connections</b>	Custom
<b>Temperature Range</b>	2 - 49°C
<b>Inlet Pressure (Min/Max)</b>	2 / 8,6 bar



3

11020

## Premier 2060s

The Premier 2060s can operate in either a maximum flow or maximum efficiency configuration.

- Twin-tank, non-electric water softener.
- Large capacity tanks for salt storage.



### Specifications:

<b>Dimensions</b>		
<b>System (w x d x h)</b>	432 x 203 x 1168 mm	
<b>Weight</b>	64 - 91 kg	
<b>Type</b>	<b>Standard</b>	<b>Overdrive</b>
<b>Performance</b>		
<b>Minimum Flow</b>	1,1 l/min	2,8 l/min
<b>Maximum Flow @ 1 Δ bar</b>	44 l/min	78 l/min
<b>Hardness as CaCO<sub>3</sub> (max)</b>	1129 mg/l	515,52 mg/l
<b>Regeneration</b>		
<b>Salt Used / Capacity</b>	1,2 - 2,0/114 kg	1,2 - 2,0/114 kg
<b>Time</b>	45 minutes	45 minutes
<b>Volume</b>	132 litres	132 litres
<b>System</b>		
<b>Media Volume</b>	2 x 19,8 litres	2 x 19,8 litres
<b>Inlet/Outlet Connections</b>	Custom	Custom
<b>Temperature Range</b>	2 - 49°C	2 - 49°C
<b>Inlet Pressure (Min/Max)</b>	2 / 8,6 bar	2 / 8,6 bar



3

S: 11006

OD: 11201

## Premier 2100s

This commercial softener can be configured to either an Overdrive or Alternating set-up.

- High flow rate and easy to maintain.
- Twin-tank, non-electric water softener.



### Specifications:

Dimensions		
<b>System (w x d x h)</b>	533 x 254 x 1524 mm	
<b>Weight</b>	79 - 159 kg	
Type	Standard	Overdrive
Performance		
<b>Minimum Flow</b>	1,1 l/min	1,1 l/min
<b>Maximum Flow @ 1 Δ bar</b>	45 l/min	79 l/min
<b>Hardness as CaCO<sub>3</sub> (max)</b>	1830 mg/l	975 mg/l
Regeneration		
<b>Salt Used / Capacity</b>	2,5 - 6,8/114 kg	2,5 - 6,8/114 kg
<b>Time</b>	90 minutes	90 minutes
<b>Volume</b>	386 litres	386 litres
System		
<b>Media Volume</b>	2 x 42 litres	2 x 42 litres
<b>Inlet/Outlet Connections</b>	Custom	Custom
<b>Temperature Range</b>	2 - 49°C	2 - 49°C
<b>Inlet Pressure (Min/Max)</b>	2 / 8,6 bar	2 / 8,6 bar



2

S: 11031

OD: 11128

## Premier 2175s

The Premier 2175s has been designed with an extra large salt capacity to cope with extreme levels of hardness.

- Extra large capacity tanks for salt storage.
- Twin-tank, non-electric system with large salt storage.



### Specifications:

Dimensions		
<b>System (w x d x h)</b>	686 x 330 x 1524 mm	
<b>Weight</b>	136 - 204 kg	
Performance		
<b>Minimum Flow</b>	1,1 l/min	
<b>Maximum Flow @ 1 Δ bar</b>	61 l/min	
<b>Hardness as CaCO<sub>3</sub> (max)</b>	2993 mg/l	
Regeneration		
<b>Salt Used / Capacity</b>	6,8 - 13,6 / 227 kg	
<b>Time</b>	90 minutes	
<b>Volume</b>	538 litres	
System		
<b>Media Volume</b>	2 x 64 litres	
<b>Inlet/Outlet Connections</b>	Custom	
<b>Temperature Range</b>	2 - 49°C	
<b>Inlet Pressure (Min/Max)</b>	2 / 8,6 bar	



1

11036

## CP 213s

After setting the flow configuration and meter volume, the system will automatically provide soft water, 24/7.

- Variable meter ranges allow for high setting accuracy.
- Twin-tank, non-electric water softener.



### Specifications:

<b>Dimensions</b>		
<b>System (w x d x h)</b>	686 x 330 x 1524 mm	
<b>Weight</b>	188 x 324 kg	
<b>Type</b>	<b>Standard</b>	<b>Overdrive</b>
<b>Performance</b>		
<b>Minimum Flow</b>	2,8 l/min	2,8 l/min
<b>Maximum Flow @ 1 Δ bar</b>	76 l/min	106 l/min
<b>Hardness as CaCO<sub>3</sub> (max)</b>	872 mg/l	872 mg/l
<b>Regeneration</b>		
<b>Salt Used / Capacity</b>	6,8 - 11,3 / 227 kg	
<b>Time</b>	90 minutes	
<b>Volume</b>	538 litres	
<b>System</b>		
<b>Media Volume</b>	2 x 71 litres	
<b>Inlet/Outlet Connections</b>	Custom	
<b>Temperature Range</b>	2 - 49°C	
<b>Inlet Pressure (Min/Max)</b>	2 / 8,6 bar	



1

S: 11180-DK

OD: 11180

## CP 216s

The CP 216s OD water softener is designed to provide a continuous flow of soft water for large applications.

- User-configured flow path for maximum flexibility.
- Twin-tank, non-electric water softener.



### Specifications:

<b>Dimensions</b>		
<b>System</b>	838 x 406 x 1803 mm	
<b>Weight</b>	302 - 538 kg	
<b>Type</b>	<b>Standard</b>	<b>Overdrive</b>
<b>Performance</b>		
<b>Minimum Flow</b>	4,2 l/min	4,2 l/min
<b>Maximum Flow @ 1 Δ bar</b>	87 l/min	132 l/min
<b>Hardness as CaCO<sub>3</sub> (max)</b>	838 mg/l	838 mg/l
<b>Regeneration</b>		
<b>Salt Used / Capacity</b>	10,9 - 18,1 / 228 kg	
<b>Time</b>	90 minutes	
<b>Volume</b>	606 litres	
<b>System</b>		
<b>Media Volume</b>	2 x 113 litres	
<b>Inlet/Outlet Connections</b>	Custom	
<b>Temperature Range</b>	2 - 49°C	
<b>Inlet Pressure (Min/Max)</b>	2 / 8,6 bar	



1

S: 11182-DK

OD: 11182

## CC 206c

**A high performance, compact commercial water softener, ideal for applications where space is limited.**

The CC206c is a best-in-class, compact commercial softener that is incredibly quick and easy to install. The castors also make it easy to move around the kitchen when cleaning.

- Durable, compact cabinet design.
- Casters allow for easy system movement.
- Highly efficient commercial water softener.
- Regenerates only on demand.



### Specifications:

<b>Dimensions</b>	
<b>System (w x d x h)</b>	356 x 356 x 559 mm
<b>Weight</b>	27,2 - 49,9 kg
<b>Performance</b>	
<b>Minimum Flow</b>	1,1 l/min
<b>Maximum Flow @ 1 Δ bar</b>	34,5 l/min
<b>Hardness as CaCO<sub>3</sub> (max)</b>	513 mg/l
<b>Regeneration</b>	
<b>Salt Used / Capacity</b>	0,23 - 0,45 / 18 kg
<b>Time</b>	11 minutes
<b>Volume</b>	19 litres
<b>System</b>	
<b>Media Volume</b>	2 x 4,5 litres
<b>Inlet/Outlet Connections</b>	Custom
<b>Temperature Range</b>	2 - 65°C
<b>Inlet Pressure (Min/Max)</b>	2 / 8,6 bar



## CC 208c

The CC 208c is a highly efficient, compact commercial water softener.

- Durable cabinet design.
- Simple installation with variable quick-connect adapters.



### Specifications:

<b>Dimensions</b>	
<b>System (w x d x h)</b>	508 x 559 x 711 mm
<b>Weight</b>	45 - 100 kg
<b>Performance</b>	
<b>Minimum Flow</b>	1,1 l/min
<b>Maximum Flow @ 1 Δ bar</b>	38,6 l/min
<b>Hardness as CaCO<sub>3</sub> (max)</b>	684 mg/l
<b>Regeneration</b>	
<b>Salt Used / Capacity</b>	0,45 - 0,64 / 45 kg
<b>Time</b>	11 minutes
<b>Volume</b>	53 litres
<b>System</b>	
<b>Media Volume</b>	2 x 11 litres
<b>Inlet/Outlet Connections</b>	Custom
<b>Temperature Range</b>	2 - 65°C
<b>Inlet Pressure (Min/Max)</b>	2 / 8,6 bar



4

11500B-INT

## AquaKinetic HT

A high performance, ultra-compact water softener, the AquaKinetic HT can fit into the smallest of spaces.

- Twin-tank, non-electric water softener.
- Economical to use, also available with casters.



### Specifications:

<b>Dimensions</b>	
<b>System (w x d x h)</b>	178 x 457 x 508 mm
<b>Weight</b>	21 kg
<b>Performance</b>	
<b>Minimum Flow</b>	2 l/min
<b>Maximum Flow @ 1 Δ bar</b>	19,3 l/min
<b>Hardness as CaCO<sub>3</sub> (max)</b>	513 mg/l
<b>Regeneration</b>	
<b>Salt Used / Capacity</b>	0,45 / 9 kg
<b>Time</b>	11 minutes
<b>Volume</b>	34 litres
<b>System</b>	
<b>Media Volume</b>	2 x 4,5 litres
<b>Inlet/Outlet Connections</b>	Custom
<b>Temperature Range</b>	2 - 65°C
<b>Inlet Pressure (Min/Max)</b>	2 / 8,6 bar



18

110064



# Kinetico Simplex H

The NEW Kinetico Simplex H is a single tank water softener with full demand-driven flexibility.

- High performance system that regenerates on demand.
- Designed to withstand tough working conditions.



## Specifications:

<b>Dimensions</b>	
<b>System (w x d x h)</b>	230 x 410 x 555 mm
<b>Weight</b>	25 kg
<b>Performance</b>	
<b>Minimum Flow</b>	1,1 l/min
<b>Maximum Flow @ 1 Δ bar</b>	20 l/min
<b>Hardness as CaCO<sub>3</sub> (max)</b>	555 mg/l
<b>Regeneration</b>	
<b>Salt Used / Capacity</b>	0,27 kg
<b>Time</b>	11 minutes
<b>Volume</b>	25 litres
<b>System</b>	
<b>Media Volume</b>	4,5 litres
<b>Inlet/Outlet Connections</b>	Custom
<b>Temperature Range</b>	2 - 49°C
<b>Inlet Pressure (Min/Max)</b>	2 / 8,6 bar

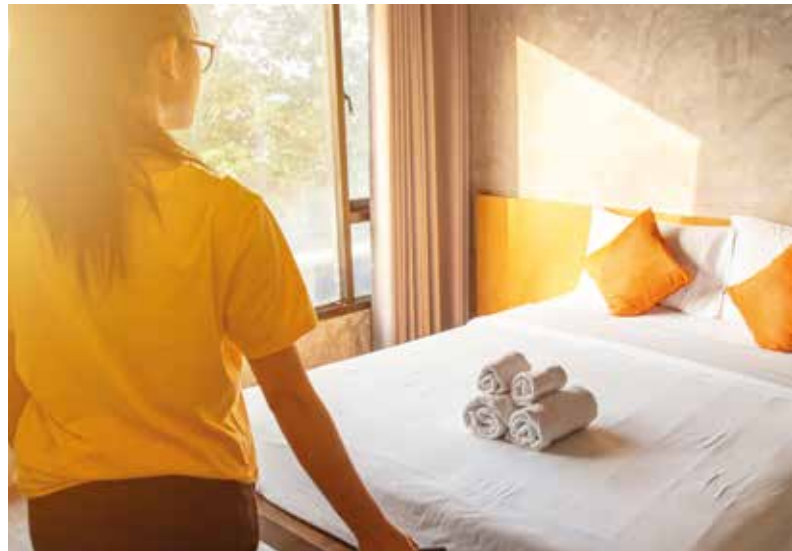

27

100060



# Water Filtration Systems

---

Kinetico filters are fitted with a non-electric control valve to provide a continuous flow of filtered water, 24/7.

Kinetico guarantees pure, crystal clear water. No cloudiness, color or odour is accepted in the Kinetico world. To ensure best performance Kinetico filtration units backwash based on demand. It is water usage that determines when filtration media needs to be washed.

Kinetico systems can provide filtration from just a few to hundreds of litres per minute. Based on the needs of the application, Kinetico systems can be customized with several different media configurations: Calcite, Carbon and **a special media, Macrolite.**

Made to withstand the harshest environments, the tanks are built to resist heat, moisture and corrosion. This ensures that Kinetico systems last for a long time, with minimum maintenance cost. To protect the systems from inside, filtered water is used to backwash the system. This also maximizes the media performance and improves the water quality. **Kinetico always strives to provide the best results possible.**

# Water Filtration made easy with Kinetico



## Say goodbye to...

Foul smelling water and the appearance of debris in a water supply.

## Say goodbye to...

Brown staining on linen and the need for frequent linen replacement.



# The Range

---

## Filtration Range

---



**Premier 2030f OD**  
Macrolite



**Premier 2060f OD**  
Macrolite and Carbon



**Premier 2100f OD**  
Macrolite and Carbon



**CP 213f OD**  
Macrolite and Carbon

## Premier 2030f OD

The smallest Kinetico commercial non-electric filtration unit. Backwashes based on demand.

- Uninterrupted 24/7 performance.
- Compact, small in size, twin-tank water filter.



### Specifications:

<b>Dimensions</b>	
<b>System</b>	381 x 178 x 1041 mm
<b>Weight</b>	47,6 - 64 kg
<b>Type</b>	<b>Macrolite</b>
<b>Performance</b>	
<b>Minimum Flow</b>	2 l/min
<b>Maximum Flow @ 1 Δ bar</b>	15 l/min
<b>Backwash</b>	
<b>Time</b>	20 minutes
<b>Volume</b>	257 litres
<b>System</b>	
<b>Media Volume</b>	2 x 7 litres
<b>Inlet/Outlet Connections</b>	Custom
<b>Temperature Range</b>	2 - 49°C
<b>Inlet Pressure (Min/Max)</b>	2 / 8,6 bar



7

12662-INT

## Premier 2060f OD

Compact size water filter designed to produce a continuous supply of filtered water, without breaks.

- Non-electric, twin-tank water filter.
- Various media options available.



### Specifications:

<b>Dimensions</b>		
<b>System</b>	432 x 203 x 1168 mm	
<b>Weight</b>	54 - 136 kg	
<b>Type</b>	<b>Macrolite</b>	<b>Carbon</b>
<b>Performance</b>		
<b>Minimum Flow</b>	1,1 l/min	1,1 l/min
<b>Maximum Flow @ 1 Δ bar</b>	27 l/min	15 l/min
<b>Backwash</b>		
<b>Time</b>	20 minutes	20 minutes
<b>Volume</b>	322 litres	322 litres
<b>System</b>		
<b>Media Volume</b>	2 x 11,3 litres	2 x 19,8 litres
<b>Inlet/Outlet Connections</b>	Custom	Custom
<b>Temperature Range</b>	2 - 49°C	2 - 49°C
<b>Inlet Pressure (Min/Max)</b>	2 / 8,6 bar	2 / 8,6 bar



6

Macrolite: 11211

Carbon: 11207

## Premier 2100f OD

High performance water filter, in a modular design, allowing to expand the capacity, when needed.

- Twin-tank, non-electric water filter.
- Adjustable media option available.



### Specifications:

Dimensions		
<b>System</b>	533 x 254 x 1524 mm	
<b>Weight</b>	86 - 204 kg	
Type	Macrolite	Carbon
<b>Performance</b>		
<b>Minimum Flow</b>	1,1 l/min	1,1 l/min
<b>Maximum Flow @ 1 Δ bar</b>	38 l/min	19 l/min
<b>Backwash</b>		
<b>Time</b>	20 minutes	20 minutes
<b>Volume</b>	492 litres	492 litres
<b>System</b>		
<b>Media Volume</b>	2 x 20 litres	2 x 42,5 litres
<b>Inlet/Outlet Connections</b>	Custom	Custom
<b>Temperature Range</b>	2 - 49°C	2 - 49°C
<b>Inlet Pressure (Min/Max)</b>	2 / 8,6 bar	2 / 8,6 bar



4

Macrolite: **11146**Carbon: **11147**

## CP 213f OD

Durable, non-electric commercial water filter for the maximum performance capable of expanding capacity.

- Kinetico patented filtration media available.
- Twin-tank, demand-based backwashing, water filter.



### Specifications:

Dimensions		
<b>System</b>	686 x 330 x 1524 mm	
<b>Weight</b>	136 - 272 kg	
Type	Macrolite	Carbon
<b>Performance</b>		
<b>Minimum Flow</b>	2,8 l/min	2,8 l/min
<b>Maximum Flow @ 1 Δ bar</b>	45 l/min	38 l/min
<b>Backwash</b>		
<b>Time</b>	20 minutes	20 minutes
<b>Volume</b>	492 litres	492 litres
<b>System</b>		
<b>Media Volume</b>	2 x 57 litres	2 x 57 litres
<b>Inlet/Outlet Connections</b>	Custom	Custom
<b>Temperature Range</b>	2 - 49°C	2 - 49°C
<b>Inlet Pressure (Min/Max)</b>	2 / 8,6 bar	2 / 8,6 bar



3

Macrolite: **11246**Carbon: **11244**





# Combination Systems

---

Kinetico systems are made to be efficient and effective at removing the impurities found in water. For those cases, where there is more than one problem in the water supply, Kinetico has developed a range of Combination systems.

Combination systems combine two, dual function systems with Kinetico twin-tank technology, essentially making them four systems in one. Fitted with a non-electric control valve they provide continuous flow of treated water.

Combination units are made to filter the water and remove hardness at the same time. This eliminates the need for separate systems, saving money and space. More importantly, maintenance is reduced to a minimum as the unit only regenerates on soft and clean water, thus prolonging its lifetime.

Media is contained in separate tanks, making it easy to replace without disturbing or dismantling other parts of the system. Furthermore, the unit can be customized to your own specific needs by choosing different types of media.

Kinetico Combination systems provide the highest quality water - it is softened and filtered at the same time. With a combination system you can reach the best results in the most compact and cost efficient way.

# Dual Water Treatment made easy with Kinetico



## Say goodbye to...

Suspicious water and its unpleasant residue.

## Say goodbye to...

Malfunction of your favourite appliances.



# The Range

---

## Combination Range

---



**Premier 4040s OD**  
Carbon



**Premier 4060s OD**  
Macrolite, Carbon,  
Macrolite & Carbon



## Premier 4040s OD (carbon)

The Premier 4040s is essentially 4 systems in one, providing on demand particle filtration and water softening.

- Continuous availability of treated water 24/7.
- Easy to install and maintain, non-electric system.



### Specifications:

<b>Dimensions</b>	
<b>System (w x d x h)</b>	432 x 203 x 1067 mm
<b>Weight</b>	73 - 91 kg
<b>Performance</b>	
<b>Minimum Flow</b>	1,1 l/min
<b>Maximum Flow @ 1 Δ bar</b>	41,6 l/min
<b>Hardness as CaCO<sub>3</sub> (max)</b>	752 mg/l
<b>Regeneration</b>	
<b>Salt Used / Capacity</b>	0,5 / 113 kg
<b>Time</b>	11 minutes
<b>Volume</b>	49 litres
<b>System</b>	
<b>Media Volume</b>	2 x 11/11 litres (resin/carbon)
<b>Inlet/Outlet Connections</b>	Custom
<b>Maximum Temperature</b>	2 - 49°C
<b>Inlet Pressure (Min/Max)</b>	2 / 8,6 bar



## Premier 4060s OD

### Our unique non-electric softening and filtration system.

Kinetico Premier 4060 is one of the most unique systems on the market. The non-electric dual twin-tank system guarantees a continuous supply of treated water 24/7.

- Space efficient unit built in layers.
- Easy to install and maintain.
- Adaptable to individual needs for filtration only, or filtration and softening.
- Regenerates based on demand ensuring a longer lifetime of the system.



### Specifications:

Dimensions			
<b>System (w x d x h)</b>	432 x 203 x 1219 mm	432 x 203 x 1219 mm	432 x 203 x 1219 mm
<b>Weight</b>	73 - 91 kg	73 - 91 kg	73 - 91 kg
<b>Type</b>	<b>S Macrolite</b>	<b>S Carbon</b>	<b>F Macrolite &amp; Carbon</b>
<b>Performance</b>			
<b>Minimum Flow</b>	1,1 l/min	1,1 l/min	1,1 l/min
<b>Maximum Flow @ 1 Δ bar</b>	43,5 l/min	43,5 l/min	42 l/min
<b>Hardness as CaCO<sub>3</sub> (max)</b>	718 mg/l	530 mg/l	Filtration only
<b>Regeneration</b>			
<b>Salt Used / Capacity</b>	2,0 / 113 kg	1,5 - 1,8 / 113 kg	-
<b>Time</b>	40 minutes	40 minutes	20 minutes
<b>Volume</b>	246 litres	189 litres	284 litres
<b>System</b>			
<b>Media Volume</b>	2 x 5,7 M/20 Resin litres	2 x C 7/20 Resin litres	2 x 5,7 M/11 Resin litres
<b>Inlet/Outlet Connections</b>	Custom	Custom	Custom
<b>Maximum Temperature</b>	2 - 49°C	2 - 49°C	2 - 49°C
<b>Inlet Pressure (Min/Max)</b>	2 / 8,6 bar	2 / 8,6 bar	2 / 8,6 bar



Macrolite: 3 Carbon: 3 MacCar: 6

Macrolite: **11223**

Carbon: **11215**

MacCar: **11232**



# Drinking Water Systems

---

Kinetico Drinking Water Systems provide protection against a wide variety of contaminants with maximum water efficiency.

Our systems are flexible and expandable to meet any drinking water requirement. Customizable cartridge options allow the user to effectively tackle their water problems.

Stylish, minimalistic designs suit various tastes. The compact systems take up very little space and still provide best-in-class performance. Simplified maintenance ensures that every household can maintain its own system, by quickly disconnecting and replacing the cartridges.

Furthermore, high performance reverse osmosis membranes produce high quality water at a fast rate, so water is ready when needed, without delay.

And, unique EverClean technology rinses the membranes of our premium units to make sure the system will last for many years. The handy Puremeter indicator will let you know exactly when the drinking water system requires maintenance, only the best customer experience from Kinetico.

# Drinking Water Filtration made easy with Kinetico



## Say goodbye to...

A limescaled kettle and a chalky layer of scum on hot drinks.

## Say goodbye to...

The risk of consuming lead, pesticides, viruses and bacteria. These may be present in a drinking water supply.





# The Range

## Reverse Osmosis Filtration Range



## Filtration Range



## K5

**This revolutionary drinking water system is so advanced it can remove nearly everything from tap water that isn't water.**

The Kinetico K5 produces crystal clear, great tasting water straight from a tap, on demand, 24/7.

- Reverse osmosis system with up to 5 cartridge options.
- Unique QuickFlo® tank technology to ensure a strong and steady flow.
- Patented and exclusive EverClean® Rinse to prolong life of RO membrane.
- PureMometer® to show filter life.
- MACguard® to minimize flow of unfiltered water.



### Specifications:

<b>Dimensions</b>	
<b>System (w x d x h)</b>	150 x 394 x 483 mm
<b>Weight</b>	12,2 kg
<b>Flow</b>	
<b>Pressure Range</b>	2,5 - 8,5 bar
<b>Production</b>	
<b>Daily Production Rate</b>	130 - 193 litres/day
<b>Reject Rate (NaCl/CaCO3)</b>	98 - 99%
<b>System</b>	
<b>Storage Tank</b>	11 litres
<b>Prefilter</b>	Carbon Sediment
<b>Temperature Range</b>	1,7 - 37,8°C
<b>Postfilter</b>	Activated Carbon Block
<b>Additional Cartridges</b>	2 (optional)

Pre-filter - 5 Carbon/Sediment

Post-filter - Activated Carbon Block

Membrane

### Available extras:

Purefecta®, Mineral Plus, Arsenic, VOC Guard



16



13342-FAU

## K2

The K2 uses a three-stage process to guarantee perfect water every time you turn your tap.

- Non-electric water filtration unit.
- Filtered water on tap 24/7, with a high flow rate.



### Specifications:

<b>Dimensions</b>	
<b>System (w x d x h)</b>	127 x 330 x 406 mm
<b>Weight</b>	8,5 kg
<b>Flow</b>	
<b>Pressure Range</b>	2,5 - 6,9 bar
<b>Production</b>	
<b>Daily Production Rate</b>	41,2 litres/day
<b>Reject Rate (NaCl/CaCO<sub>3</sub>)</b>	98 - 99%
<b>System</b>	
<b>Storage tank</b>	11 litres
<b>Prefilter</b>	Carbon Sediment
<b>Temperature Range</b>	1,7 - 37,8°C
<b>Postfilter</b>	Activated Carbon Block



20

4021-DK

## Premier RO

The Premier RO uses a two-stage filtration process to produce delicious filtered water on demand.

- Remove 99.9% of heavy metals and bacteria.
- Two-stage reverse osmosis filtration system.



### Specifications:

<b>Dimensions</b>	
<b>System (w x d x h)</b>	155 x 485 x 415 mm
<b>Weight</b>	11,5 kg
<b>Flow</b>	
<b>Flow Rate</b>	2,1 litres/minute
<b>Production</b>	
<b>Daily Production Rate</b>	8,000 gallons/day
<b>System</b>	
<b>Power Usage</b>	100 W
<b>Power Supply</b>	Output DC36V 220V (187V - 242V) /50Hz
<b>Prefilter</b>	Carbon Sediment
<b>Temperature Range</b>	5-38°C



21

100-0006

## Mac 7000 AquaTaste

With a compact Mac 7000 enjoy delicious tasting water directly from the tap, avoiding costly bottles of water.

- Improves the taste, appearance and odour of water.
- Filtered water on tap, 24/7.



### Specifications:

<b>Dimensions</b>	
<b>System (w x d x h)</b>	127 x 127 x 381 mm
<b>Weight</b>	2,1 kg
<b>Flow</b>	
<b>Pressure Range</b>	1,4 - 8,3 bar
<b>Production</b>	
<b>Filter Production</b>	1892 litres (average lifetime)
<b>Total Dissolved Solids</b>	<4000 mg/l
<b>System</b>	
<b>VOC/Lead Removal</b>	Granular Activated Carbon
<b>Temperature Range</b>	2 - 38°C



120

4049

## Mac 7500 AquaGuard

A quality, compact water filter, the Mac 7500 provides delicious, ultra-filtered water with added protection.

- Reduce the risk of consuming lead and chlorine.
- Filtered water on tap, 24/7.



### Specifications:

<b>Dimensions</b>	
<b>System (w x d x h)</b>	127 x 127 x 381 mm
<b>Weight</b>	2,1 kg
<b>Flow</b>	
<b>Pressure Range</b>	1,4 - 8,3 bar
<b>Production</b>	
<b>Filter Production</b>	1892 litres (average lifetime)
<b>Total Dissolved Solids</b>	<4000 mg/l
<b>System</b>	
<b>VOC/Lead Removal</b>	Activated Carbon Block
<b>Taste &amp; Odour Removal</b>	Granular Activated Carbon
<b>Temperature Range</b>	2 - 38°C



120

4050

## Essential Filter

A high quality, easy to install water filter system that provides 12 months of pure filtered water.

- Reduce the risk of consuming chlorine, lead and cysts.
- Eliminate the need to buy costly bottles of water.



### Specifications:

<b>Dimensions</b>	
<b>System (d x h)</b>	100 x 370 mm
<b>Weight</b>	875g
<b>Flow</b>	
<b>Flow Rate</b>	4 litres/minute
<b>Pressure Range</b>	1,5 - 8,6 bar
<b>Production</b>	
<b>Filter Production</b>	6000 litres
<b>System</b>	
<b>VOC/Lead Removal</b>	Activated Carbon Block
<b>Taste &amp; Odour Removal</b>	Carbon
<b>Temperature Range</b>	2 - 23°C



50

100-0300

## Premier UF

With the Premier UF enjoy greater protection for all the family with ultra-filtered water on demand.

- Significantly reduce bacteria, viruses and chlorine.
- Ultra-filtered water on tap 24/7.



### Specifications:

<b>Dimensions</b>	
<b>System (d x h)</b>	100 x 370 mm
<b>Weight</b>	875g
<b>Flow</b>	
<b>Flow Rate</b>	4 litres/minute
<b>Pressure Range</b>	1,5 - 8,6 bar
<b>Production</b>	
<b>Filter Production</b>	6000 litres
<b>System</b>	
<b>VOC/Lead Removal</b>	5mm coconut shell, activated carbon and 1500 mg/g iodine
<b>Taste &amp; Odour Removal</b>	Ultra-filtration made of PE hollow fibre with 0.01-0.1 pore
<b>Temperature Range</b>	2 - 38°C



40

100-0500-INT



# Commercial Reverse Osmosis

---

Kinetico Commercial RO systems have been developed to be effective and efficient. The RO-Compact series has been specifically designed to supply industrial dishwashers with mineral free water. The units are space saving and can be installed under a table or a counter, right next to the dishwasher.

Kinetico Reverse Osmosis units have a high flow performance and the integrated, fully automatic by-pass ensures continuous operation.

Compact and robust, the systems are easy to install and require minimal maintenance. Furthermore, the membrane rinse prolongs their lifetime and operation.

With a Kinetico Commercial RO system your other equipment will serve you significantly longer.

Choose Kinetico for the purest water and the highest industry standards.

# Commercial Reverse Osmosis made easy with Kinetico



## Say goodbye to...

Layers of scum on teas and coffees and odours in food and drinks.

## Say goodbye to...

Cloudy ice cubes and costly ice maker maintenance.





# The Range

## Commercial Reverse Osmosis Range



**RO Compact 1**



**RO Compact 2**



**RO Compact 3**



**KPRO Compact**



**RO 401**

## RO Compact 1

The RO Compact 1 is a compact system designed to supply industrial applications with mineral free water.

- High flow performance.
- Low operational and maintenance costs.



### Specifications:

<b>Dimensions</b>	
<b>System (w x d x h)</b>	250 x 550 x 760 mm
<b>Weight</b>	43 kg
<b>Regeneration</b>	
<b>Capacity</b>	160 l/h
<b>Recovery Rate</b>	40 - 75 %
<b>Rejection Rate</b>	97 - 98 %
<b>System</b>	
<b>Reservoir</b>	35 litres
<b>Electrical Connection</b>	230 volt
<b>Power Consumption</b>	1,1 kW
<b>Water Inlet Pressure</b>	1 - 7 bar
<b>Inlet Water Quality Max</b>	1500 ppm



4

170151B

## RO Compact 2

The RO Compact 2 is ideal for use with dishwashers, ice cube machines and car washes.

- Digitally controlled system.
- Ever clean rinse in a durable design.



### Specifications:

<b>Dimensions</b>	
<b>System (w x d x h)</b>	460 x 580 x 700 mm
<b>Weight</b>	56 kg
<b>Regeneration</b>	
<b>Capacity</b>	300 l/h
<b>Recovery Rate</b>	50 - 75 %
<b>Rejection Rate</b>	97 - 98 %
<b>System</b>	
<b>Reservoir</b>	66 litres
<b>Electrical Connection</b>	230 volt
<b>Power Consumption</b>	1,1 kW
<b>Water Inlet Pressure</b>	1 - 7 bar
<b>Inlet Water Quality Max</b>	1500 ppm



2

170152B

# RO Compact 3

## A compact Reverse Osmosis system with simplified maintenance and great performance.

The Kinetico RO Compact 3 has been specially designed to supply industrial dishwashers with mineral free water. The unit is compact and space saving and can be installed under the table or counter, right next to the dishwasher.

The integrated fully automatic By-Pass ensures continuous operation of the dishwasher.

- Ever clean rinse and RO membranes.
- High flow rate commercial RO system.



### Specifications:

<b>Dimensions</b>	
<b>System (w x d x h)</b>	460 x 580 x 700 mm
<b>Weight</b>	71 kg
<b>Regeneration</b>	
<b>Capacity</b>	420 l/h
<b>Recovery Rate</b>	75 %
<b>Rejection Rate</b>	97 - 98 %
<b>System</b>	
<b>Reservoir</b>	66 litres
<b>Electrical Connection</b>	230 volt
<b>Power Consumption</b>	1,7 kW
<b>Water Inlet Pressure</b>	1 - 7 bar
<b>Inlet Water Quality Max</b>	1500 ppm



2

170153B

# KPRO Compact

The new KPRO Compact is a direct flow reverse osmosis system, suitable for multiple applications.

Install the system in front of a dishwasher, for spot free glass and tableware, or in front of an ice machine for crystal clear ice. Guarantee the perfect cup of coffee every time, with an additional blending valve, the system is the ideal accompaniment to any coffee machine.

- Ideal for dishwashers, ice and coffee machines.
- Individual system setting with SMART programming.
- Advanced RO membrane technology delivers excellent TDS levels.
- Long lifetime and low maintenance costs.
- Designed for the HORECA market.



## Specifications:

<b>Dimensions</b>	
<b>System (w x d x h)</b>	155 x 401 x 456 mm
<b>Weight</b>	10,7 kg
<b>Regeneration</b>	
<b>Production</b>	2,6 l/m
<b>Membrane</b>	1000 GPD
<b>Rejection</b>	1,0 l/m
<b>System</b>	
<b>External Programmer</b>	Smart DOT. Alarm/Setting
<b>Electrical Adapter</b>	230 VAC 50/60 hz
<b>Power Supply</b>	24 VDC / 36 VDC
<b>Water Inlet Pressure</b>	1 - 4 bar
<b>Inlet Water Quality Max</b>	1500 ppm



# RO 401

The RO 401 is a compact Reverse Osmosis system ideal for many applications.

- High flow rate.
- Compact size and easy maintenance.



## Specifications:

<b>Dimensions</b>	
<b>System (w x d x h)</b>	310 x 180 x 583 mm
<b>Weight</b>	35 kg
<b>Regeneration</b>	
<b>Capacity v/15° C</b>	160 l/h
<b>Recovery Rate</b>	40 - 60%
<b>Rejection Rate</b>	>95%
<b>System</b>	
<b>Reservoir</b>	-
<b>Electrical Connection</b>	230 volt
<b>Power Consumption</b>	0,6 kW
<b>Water Inlet Pressure</b>	1 - 7 bar
<b>Inlet Water Quality Max</b>	1500 ppm



4

401000



# Hydrus

---

The Kinetico Hydrus Series encompasses our most advanced, efficient and environmentally friendly water systems. Designed to filter and soften water, the systems are completely configurable to a specific demand and can be combined with other Hydrus filtration or softening systems for larger volume application requirements.

The non-electric valve eliminates the need for motors, maximizing the longevity of the system. Furthermore, the proven softening technology and process of countercurrent regeneration guarantee a longer lifetime and greater efficiency of the units. In addition, Hydrus units produce significantly less waste water, than comparable machines, as they regenerate based on demand and actual water usage, therefore making them more environmentally friendly.

Configurable design options include single or multi-tank set up, providing the most efficient and flexible installation solutions that meet the needs and varying space requirements of any situation. The valve and tanks are corrosion-resistant which ensures a longer lasting service and endurance, even in the harshest industrial or commercial application.

# Hydrus Water Treatment made easy with Kinetico



## Say goodbye to...

Costly maintenance and breakdowns due to limescale damage.

## Say goodbye to...

Problems associated with chlorine and organics in your water supply.





# The Range

---

## Hydrus Softening Range

---



**Hydrus Simplex**



**Hydrus Multitank**

## Hydrus Filtration Range

---



**Hydrus Simplex**



**Hydrus Multitank**

## Hydrus Simplex Softener

The Hydrus Simplex Softener is part of our most advanced, efficient and environmentally friendly series.

- Highly durable, non-corrosive valves.
- Ideal for problematic water.



### Specifications:

Type	Smallest	Largest
<b>Dimensions</b>		
<b>Height</b>	1990 mm	2770 mm
<b>Width</b>	1120 mm	2440 mm
<b>Depth</b>	610 mm	1270 mm
<b>Weight</b>		
<b>Shipping</b>	198 kg	1378 kg
<b>Operating</b>	390 kg	2566 kg

**For more information on Hydrus Softening or to request a copy of the Kinetico Industrial Brochure, please contact the Kinetico International Sales Division;**

Kinetico International Division,  
Sandvadsvej 7, Koge, DK - 4600

email: [info@kinetico.eu](mailto:info@kinetico.eu)

visit: [www.kinetico.eu](http://www.kinetico.eu)

## Hydrus Multitank Softener

A single control operates the entire softening system. Easy to set up and maintain, and cost effective to operate.

- Can be combined with Hydrus Filtration Systems.
- Modular design provides flexibility for future growth.



### Specifications:

Type	Smallest	Largest
<b>Dimensions</b>		
<b>Height</b>	1990 mm	2770 mm
<b>Width</b>	1120 mm	2160 mm
<b>Depth</b>	1320 mm	4570 mm
<b>Weight</b>		
<b>Shipping</b>	464 kg	5513 kg
<b>Operating</b>	891 kg	10262 kg

**For more information on Hydrus Softening or to request a copy of the Kinetico Industrial Brochure, please contact the Kinetico International Sales Division;**

Kinetico International Division,  
Sandvadsvej 7, Koge, DK - 4600

email: [info@kinetico.eu](mailto:info@kinetico.eu)

visit: [www.kinetico.eu](http://www.kinetico.eu)

## Hydrus Simplex Filter

The Hydrus Simplex Filter is part of our most advanced, efficient and environmentally friendly series.

- Highly durable, non-corrosive valves.
- Economical and space efficient.



### Specifications:

Type	Smallest	Largest
<b>Dimensions</b>		
<b>Height</b>	1990 mm	2760 mm
<b>Width</b>	460 mm	1060 mm
<b>Depth</b>	460 mm	1060 mm
<b>Weight</b>		
<b>Shipping</b>	144 kg	1165 kg
<b>Operating</b>	267 kg	1856 kg

**For more information on Hydrus Filtration or to request a copy of the Kinetico Industrial Brochure, please contact the Kinetico International Sales Division;**

Kinetico International Division,  
Sandvadsvej 7, Koge, DK - 4600

email: [info@kinetico.eu](mailto:info@kinetico.eu)  
visit: [www.kinetico.eu](http://www.kinetico.eu)

## Hydrus Multitank Filter

The Hydrus Multitank Filter is our most efficient system, suitable for high demand and large volume.

- Advanced operator interface.
- Configurable for demanding large volume applications.



### Specifications:

Type	Smallest	Largest
<b>Dimensions</b>		
<b>Height</b>	1990 mm	2470 mm
<b>Width</b>	1020 mm	3960 mm
<b>Depth</b>	460 mm	910 mm
<b>Weight</b>		
<b>Shipping</b>	370 kg	2993 kg
<b>Operating</b>	636 kg	5200 kg

**For more information on Hydrus Filtration or to request a copy of the Kinetico Industrial Brochure, please contact the Kinetico International Sales Division;**

Kinetico International Division,  
Sandvadsvej 7, Koge, DK - 4600

email: [info@kinetico.eu](mailto:info@kinetico.eu)  
visit: [www.kinetico.eu](http://www.kinetico.eu)

# FAQs

## What are the requirements for positioning a softener/filter?

Kinetico systems are non-electric, therefore there is a lot of freedom as to where they can be placed. No electrical sockets are needed, even damp/moist conditions are not dangerous for Kinetico systems.

### Level Surface:

Position softener and brine tank on a level surface. If within 3 meters of hot water tank, make sure an expansion tank is used.

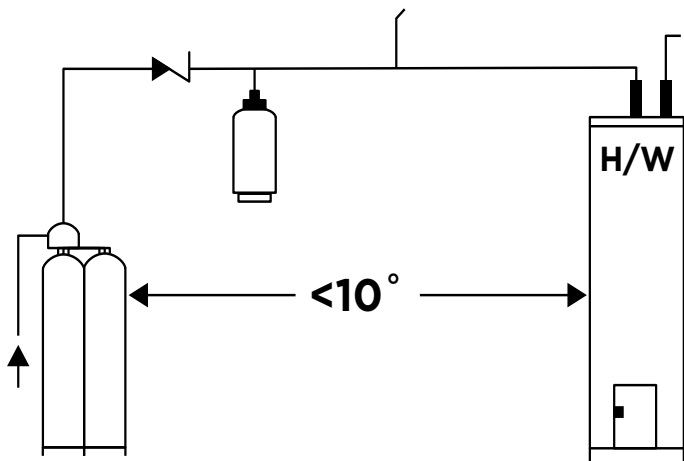

### Environmental conditions:

50° C Max., protect from freezing

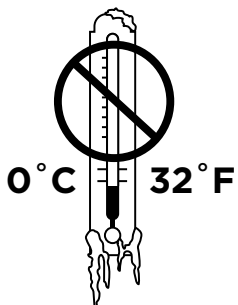

### Water conditions:

Temperature: 2 - 49°C

Pressure: 2 / 8,6 bar

## How do you maintain a Kinetico Water Softener?

Kinetico Water Softeners are non-electric. This means there are no mechanisms to set and control. They regenerate on demand based on water usage, this means there are no timers to monitor. The only action required to look after a Kinetico water softener is to add salt.

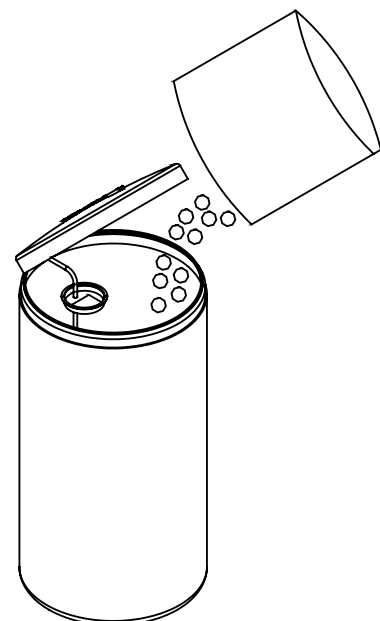
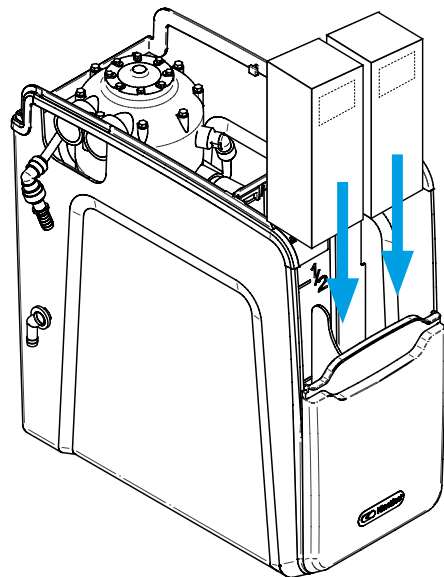

## How do you take care of a softener/filter after a long break?

For those occasions when a Kinetico softener/filter has been left unused for a long period of time, we recommend following a process of sanitisation prior to reuse. As there are no timers, when the user is on holiday, the softener has a break too, ensuring no water or salt is wasted when they are not needed. (Kinetico filters also take a break when they are not needed.)

### How to sanitise a softener:

#### Regenerate both tanks:

Using #2 Philips screwdriver, turn actuator clockwise into brine position.

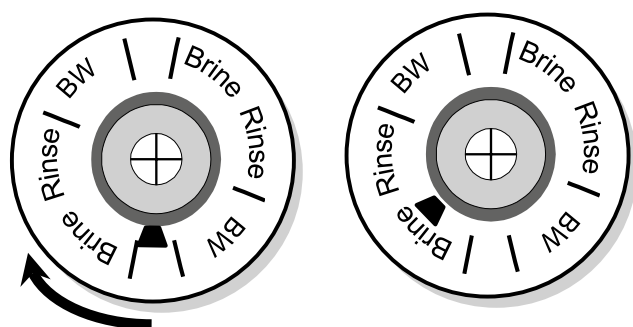

After regeneration time, initiate regeneration on second tank.

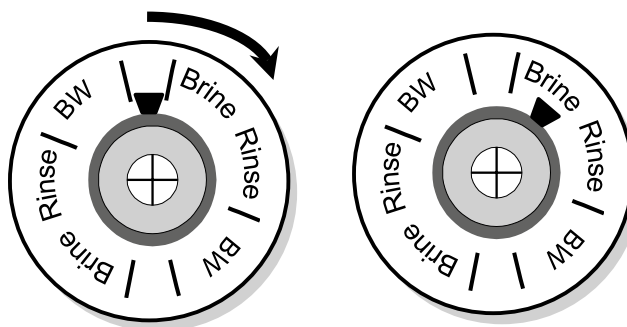

#### Use a clean grade of salt:

Use only salt appropriate for use with water treatment equipment. **DON'T USE ROCK OR SOLAR SALT.**

#### Sanitise the water softener:

Mix 29.6 ml of unscented household bleach with 15.1 litres of clean/soft water. This should make a 100 ppm solution. Use 22.7 litres for commercial units.

Put the system into by-pass.

Disconnect the brine line from the brine valve and put the 3/8" tube into the container holding the bleach mixture from the step above.

**Please note:** Do not add bleach to brine tank. Salts containing red-out additives will create hazardous fumes.

Put the system into service.

Put the unit into brine draw on one tank.

Draw the mixture until a strong bleach odour is detected (smelled or tested) in the drain line. This procedure should produce approximately 20 ppm in the mixed solution.

Switch quickly to the other tank and repeat the procedure.

Advance the control disc to the service position, then put unit into by-pass. Allow the unit to stand for 30-60 minutes.

The colder the water, the longer the stand time should be.

Reconnect the brine line (3/8" tube) to the brine tank and put unit into service. Finally, backwash each tank two times.

## How to change the meter disk in a softening/filtration/quadro system?

One Kinetico system can fit many applications, where different conditions apply. This is all thanks to the clever meter disc, which determines when a system should regenerate or backwash. The disc is determined based on the water usage and inlet water quality (see datasheets provided by Kinetico).

### Setting a meter disc:

Set the number of gallons between regenerations based on the system size and inlet water quality.

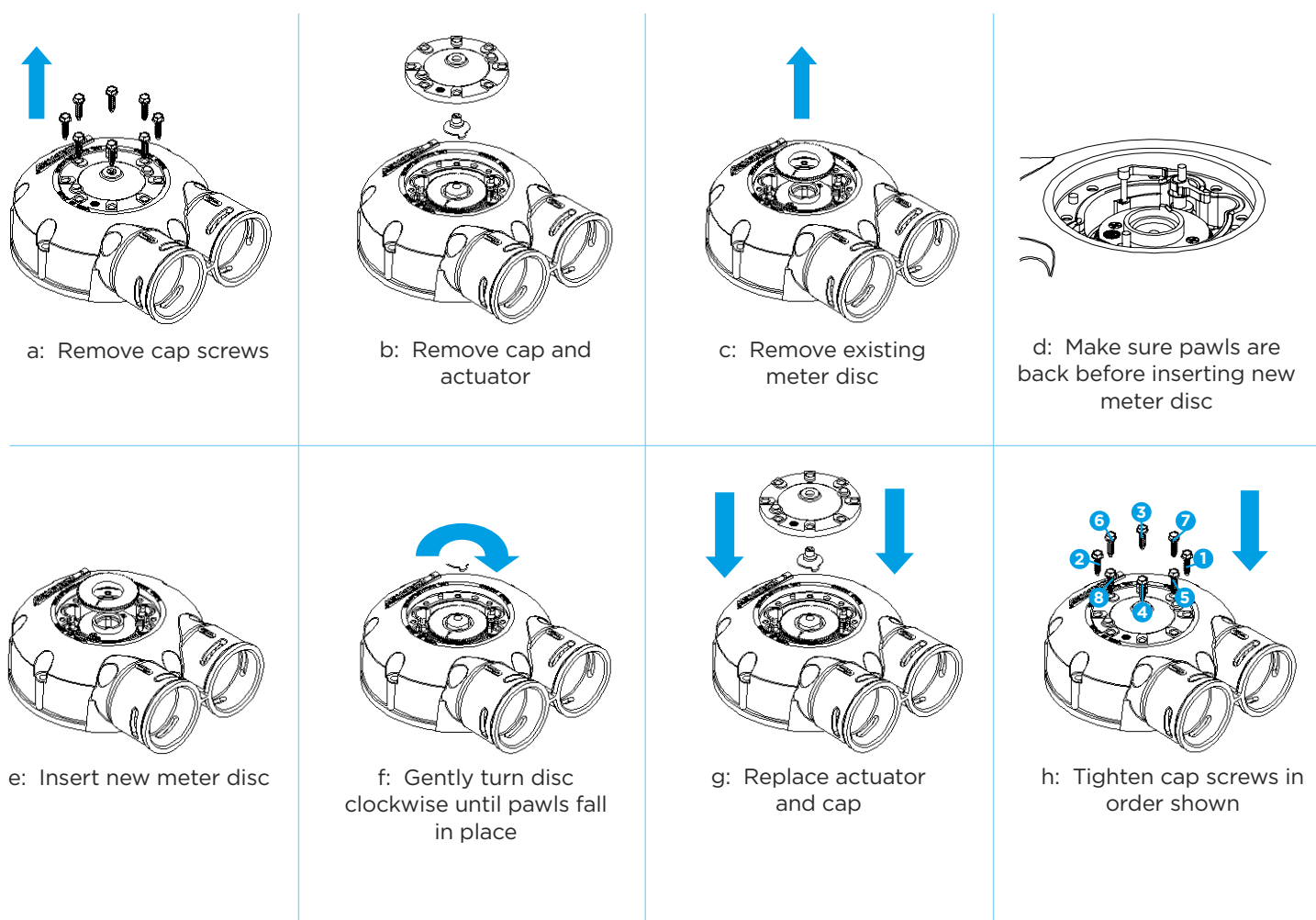

## Setting the XP:

Use the steps below to set the XP.

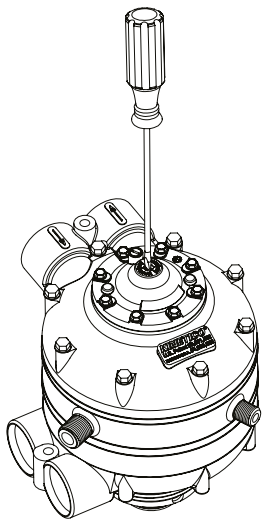

a: Manually initiate a regeneration until the XP meter is in the home position (identified by the XP arrow at the 6 o'clock position on the valve.)

b: Determine the XP meter setting (see product technical manual for required chart).

For applications containing iron, use the highest (certified where applicable) salt dosage.

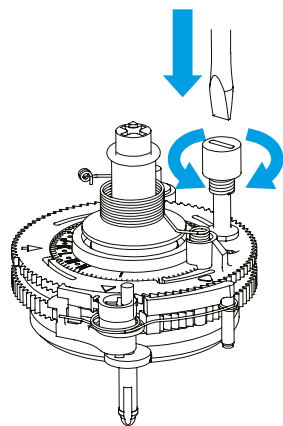

c: Adjust the XP meter setting by using a 3/16" or smaller flat-head screwdriver.

Push down and rotate the hardness adjustment knob.

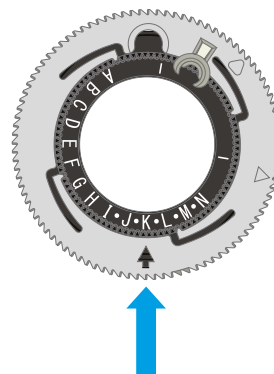

Set to K in this example

d: Set the arrow to the desired position.

The arrow points to the centre of the box for whole figure settings.

For 1/2" settings, the arrow points to the line between boxes.

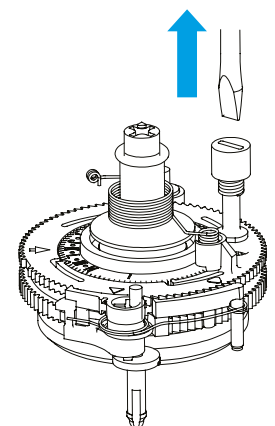

e. Release adjuster, making sure knob returns to an up position.

Notes:

NEVER set XP with the arrow aligned anywhere in the black section of the meter disc.

The softener will not meter properly.

**Legal Note:** The utmost care has been taken to provide accurate information in this catalogue. However, KINETICO shall not be held responsible for any consequences arising from any errors or omissions in the catalogue nor for any damages or accidental loss resulting from the use of the information herein.

KINETICO reserves the right to modify the products and information displayed in this catalogue without notification. The catalogue does not display the entire product range of KINETICO. Any prices listed in this catalogue do not include VAT, other charges or transportation costs. KINETICO has proprietary rights to trademarks used in this catalogue, including [Sumo], [Kube] and [Hydrus]. In this catalogue KINETICO has omitted the ® and "TM" trademark designations for such trademarks, trade names and service marks, but nevertheless reserves all rights to such trademarks, trade names and service marks.



©Kinetico 2023.